

Fast Axis Collimator Lenses (FACs) from prototype to serial production

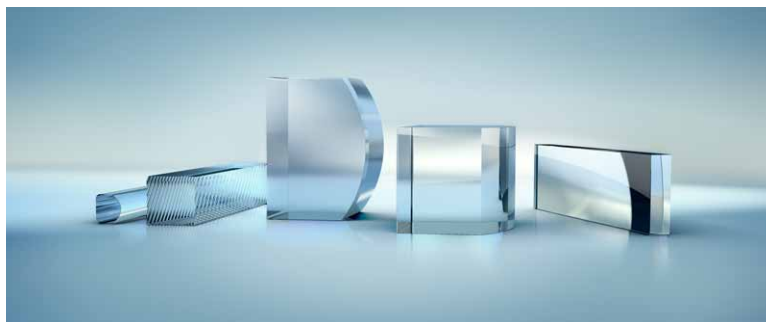
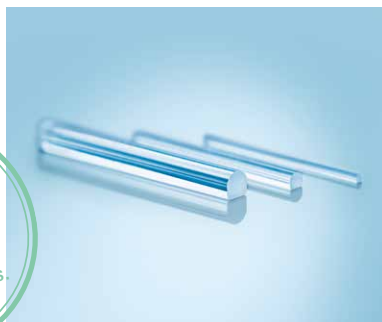
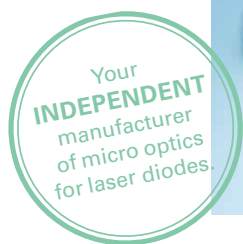

FISBA is a leading and independent supplier of FAC lenses in large quantities. Contact us for your next project regarding custom design, prototype development and large scale production.

Technical Data

- Focal length: 150 – 1700 μm
- Material: high index glass with $n > 1.8$
- Wavelength: 430 – 1550 nm
- Length: 2 – 20 mm

FISBA Capabilities

- Leading supplier of FACs in large quantities
- In-house custom design
- Prototype production
- Large scale production

Your Benefits

- Independent supplier
- Customized coating design by FISBA
- Large portfolio of standard FAC lenses
- Fast ramp-up from prototype to serial production
- Packaging according to customer request
- We ensure FACs are never the limiting factor of your production scale-up

Industries & Applications

- Diode Laser Integration
- Optical Communications

Technical Specifications

Fast Axis Collimator Lenses (FACs)

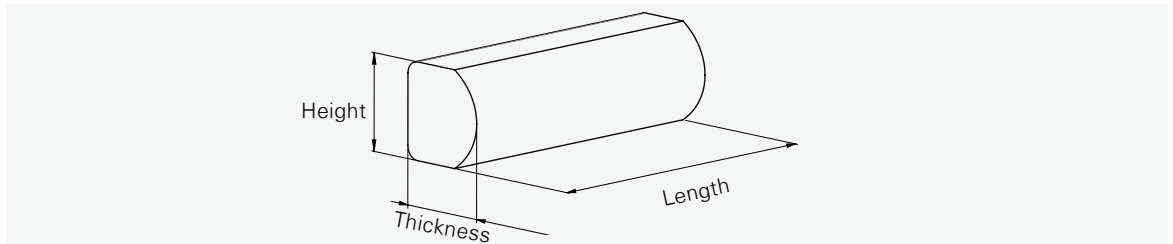

Parameters	Wavelength range nm	Numerical aperture -	Focal length EFL @ 940 nm μm	Back focal length BFL @ 940 nm μm	Residual divergence @ 85% power enclosure mrad*	Dimension (height x thickness) mm
FAC 150	790–990	0.8	150	30	±4.25	0.23 x 0.20
FAC 200	790–990 750–850	0.8	200	55	±3.25	0.33 x 0.27
FAC 300	430–470	0.75	300	70	±2.50	0.50 x 0.41
FAC 300	790–990 750–850 515–705	0.8	300	70	±2.50	0.50 x 0.43
FAC 360	790–990	0.8	360	70	±2.00	0.60 x 0.53
FAC 360	1450–1550	0.8	360	70	±2.10	0.60 x 0.53
FAC 450	790–990	0.8	450	100	±1.60	0.75 x 0.64
FAC 510	790–990	0.8	510	115	±1.50	0.90 x 0.71
FAC 600	790–990	0.8	600	140	±1.50	1.00 x 0.82
FAC 600	790–990 620–750	0.5	600	150	±1.50	0.80 x 0.82
FAC 600	430–470	0.8	600	140	±1.50	1.00 x 0.83
FAC 740	790–990	0.8	740	70	±1.25	1.20 x 1.22
FAC 900	790–990	0.8	900	90	±1.00	1.60 x 1.49
FAC 900	790–990	0.8	900	178	±1.00	1.50 x 1.34
FAC 1100	790–990	0.7	1100	110	±0.80	1.50 x 1.77
FAC 1100	790–990	0.45	1100	152	±0.95	1.10 x 1.72
FAC 1300	790–990	0.7	1300	130	±0.50	1.80 x 2.12
FAC 1500	790–990	0.5	1500	90	±0.50	1.65 x 2.58
FAC 1500	790–990	0.7	1500	90	±0.50	2.00 x 2.57
FAC 1700**	620–750 470–550 430–470	0.6	1700	1200	±0.75	2.63 x 1.24
All FAC	Transmission (%): ≥ 98 Length (mm): Variable to match your requirements					

* Measured at NA 0.29

** Design optimized for sources in TO package. BFL excluding 90μm shift due to cover glass.

Customized designs available upon request